

ELLENSBURG DENTAL  
ELLENSBURG, WASHINGTON  
SECTION 2, T-17 N, R-18 E, WM - TAX PARCEL NO. 497133

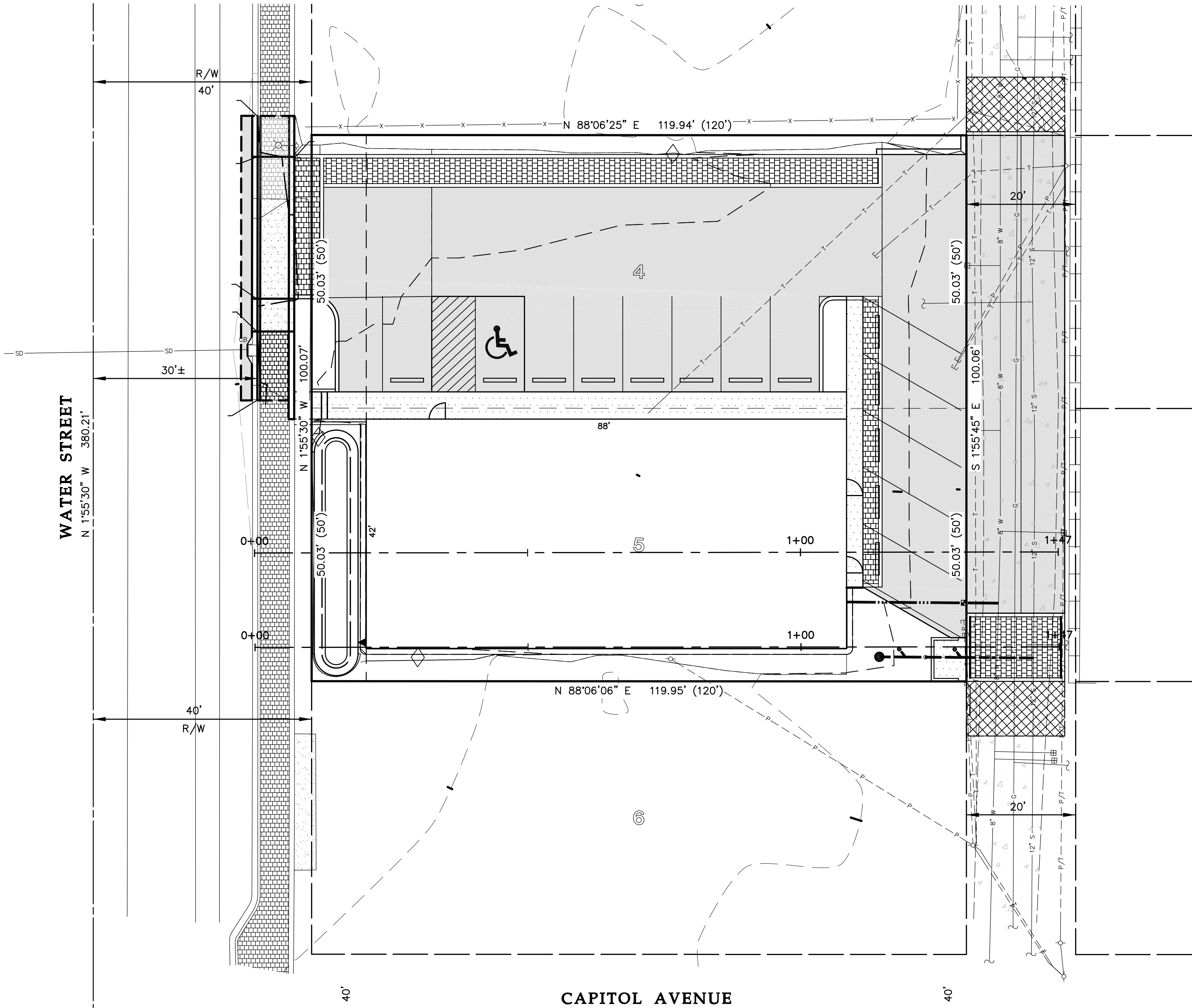

LEGEND	
PROPOSED FEATURES	EXISTING FEATURES
NEW DUCTILE IRON WATERMAIN	SECTION LINE
NEW SANITARY SEWER AS NOTED	PROPERTY/RIGHT OF WAY LINE
WATER METER	ADJOINING PROPERTY/RIGHT OF WAY
TBM	CENTER LINE
NEW PAVEMENT	FENCE (TYPE AS NOTED)
	SANITARY SEWER (AS NOTED)
	DOMESTIC WATER (AS NOTED)
	OVERHEAD POWER
	UNDERGROUND POWER
	OVERHEAD TELEPHONE
	SEWER MANHOLE
	WATER VALVE
	FIRE HYDRANT
	POWER POLE
	TELEPHONE POLE
	TELEPHONE MANHOLE
	SIGN
	MAILBOX
	DECIDUOUS TREE
	CONIFEROUS TREE

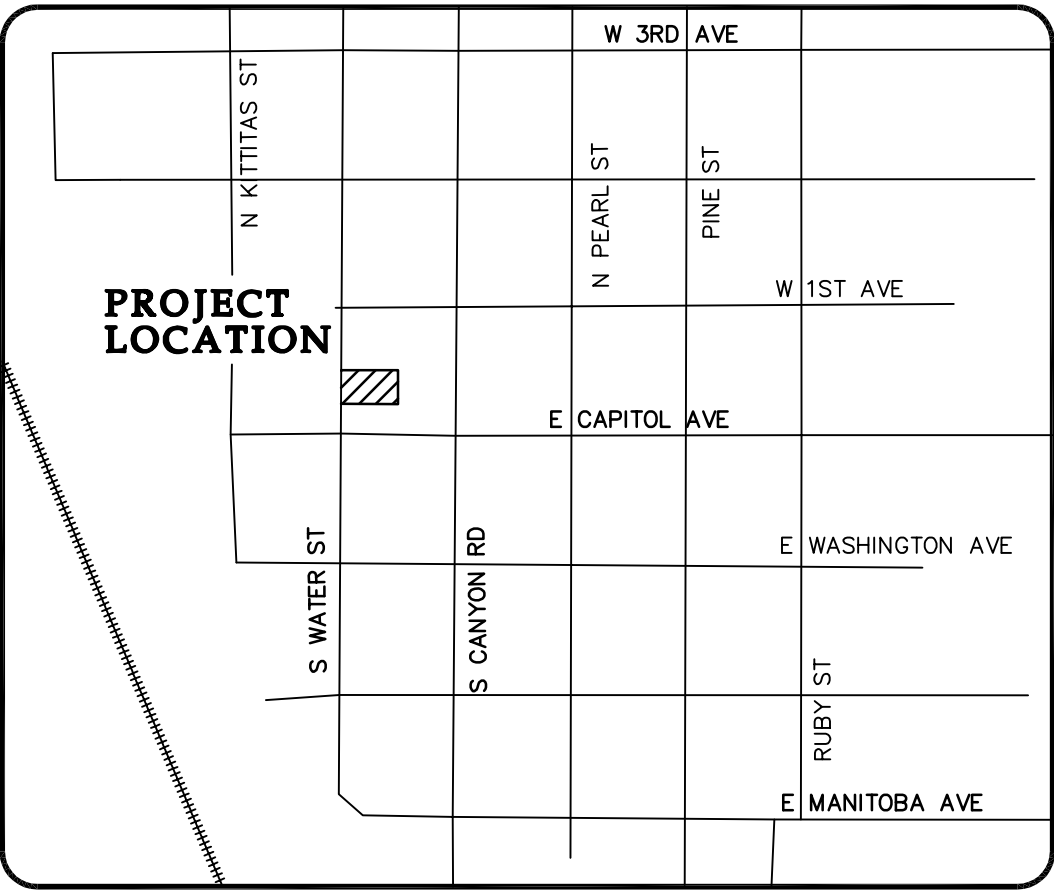

VICINITY MAP  
NO SCALE

SHEET INDEX

- SHEET 1 • COVER SHEET  
SHEET 2 • PLAN SHEET  
SHEET 3 • DETAILS  
SHEET 4 • DETAILS

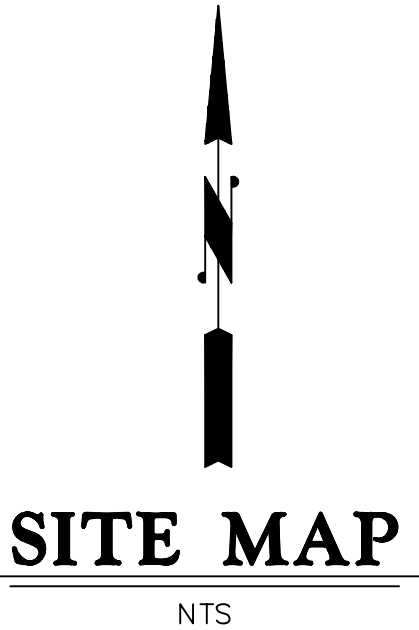

SITE MAP  
NTS

ELEVATIONS FOR THIS PROJECT WERE  
DERIVED BY GPS OBSERVATION USING THE  
WASHINGTON STATE REFERENCE NETWORK.  
(NAVD 88)

REVISION	DATE

NEW DENTAL OFFICE  
COVER SHEET  
108 S. WATER STREET  
ELLENSBURG, WASHINGTON  
PREPARED FOR  
DR. IGOR ELPERIN  
2906 W NOB HILL BLVD, YAKIMA, WA 98902 (917) 549-7026

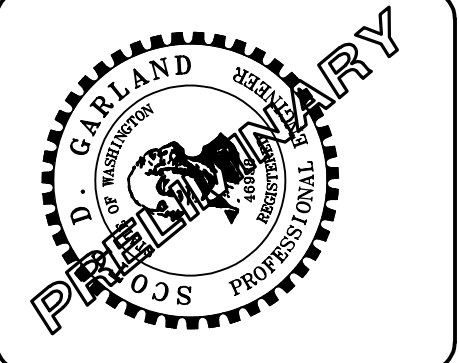

PLSA  
ENGINEERING-SURVEYING-PLANNING  
521 N. 20TH AVE. STE. 3 YAKIMA, WASHINGTON (509) 575-6990

DATE 12/23/2025	DRAWN BY T.K.L.	CHECKED BY S.D.G.	JOB NO. 25022	DWG NAME
--------------------	--------------------	----------------------	------------------	----------

SHEET 1 of 4  
CITY OF YAKIMA  
PROJ. ENG-XX-XXXX







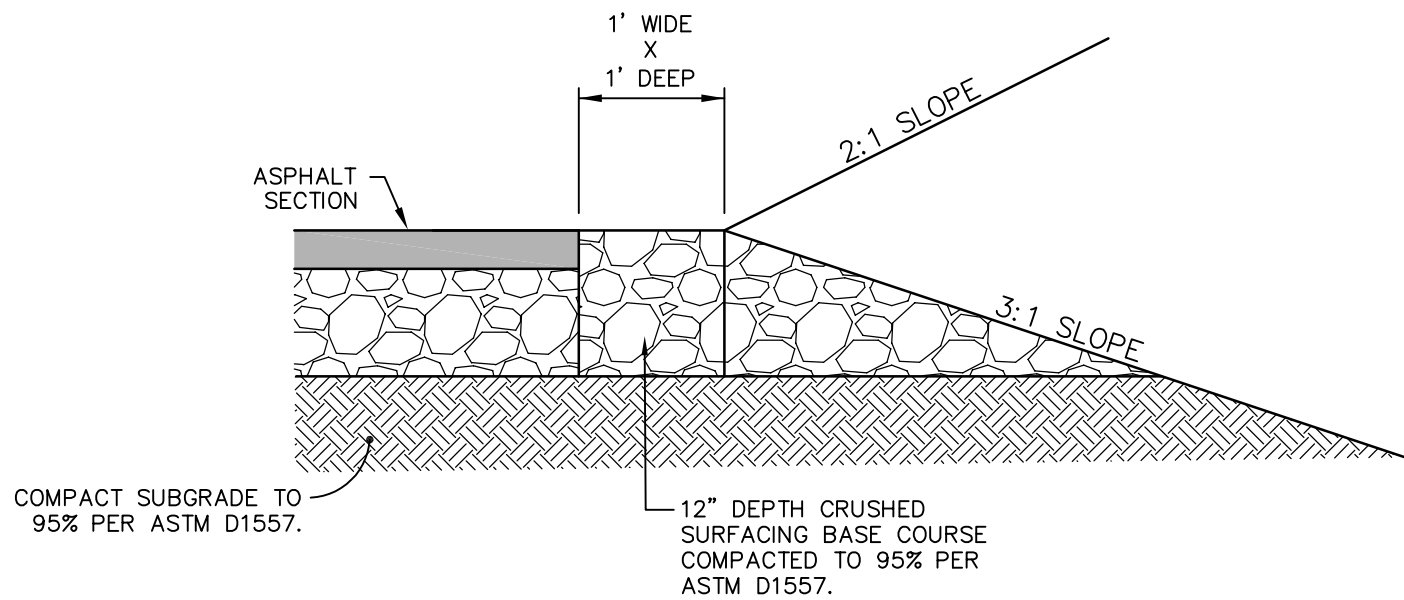

ASPHALT EDGE TREATMENT  
NO SCALE

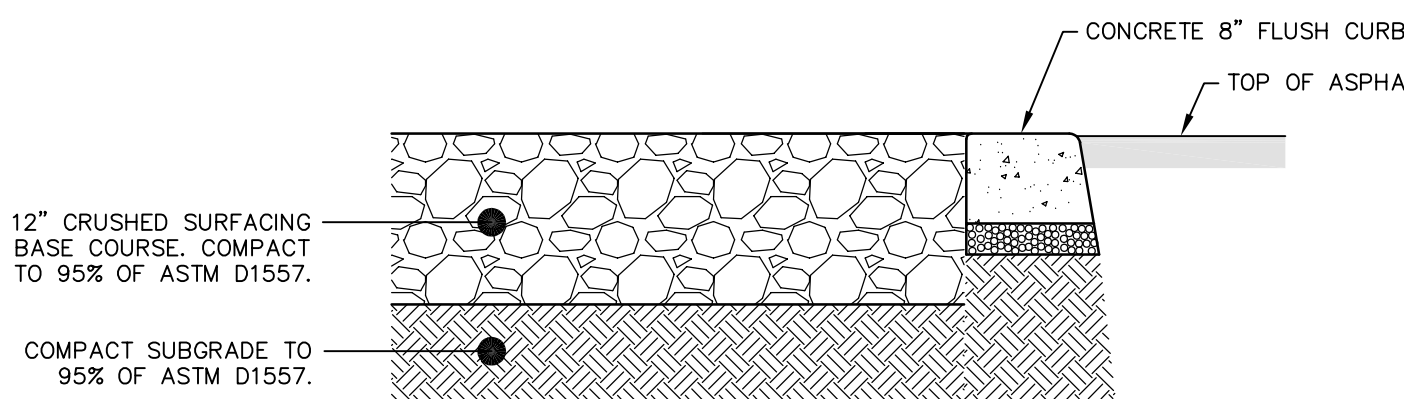

12' DEPTH GRAVEL SECTION  
NO SCALE

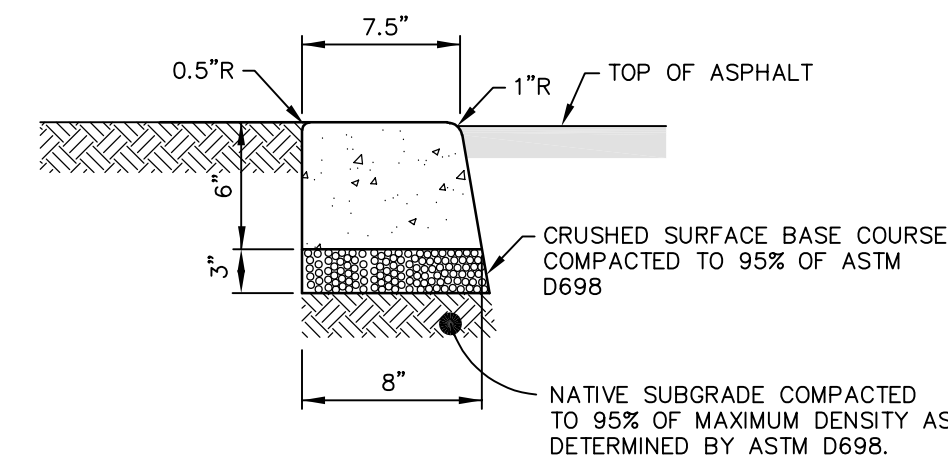

CONCRETE 8' FLUSH CURB  
NO SCALE

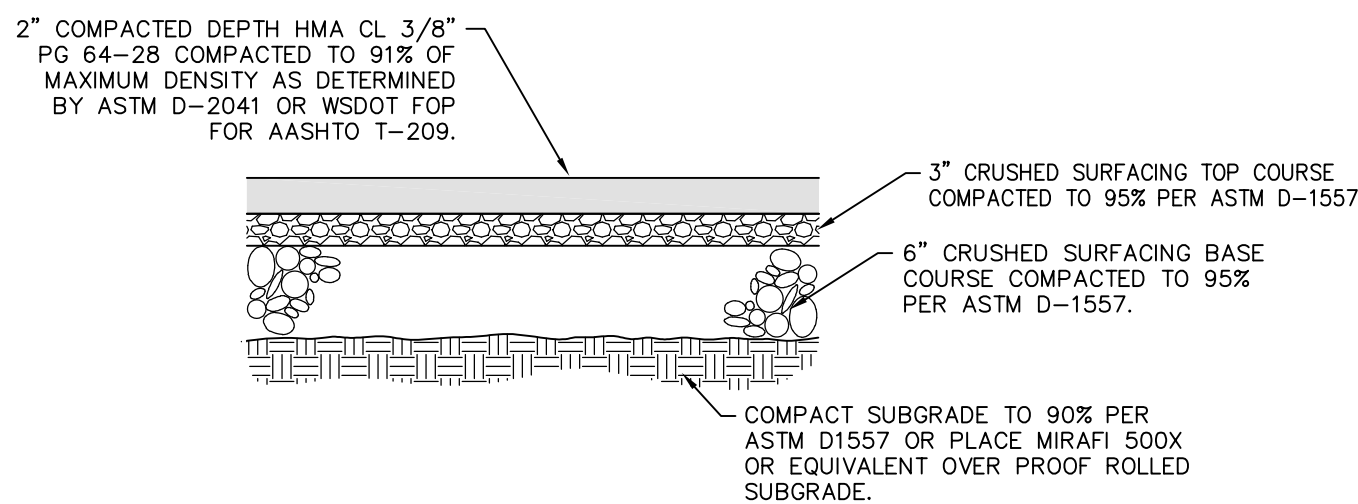

ASPHALT PAVEMENT SECTION  
NO SCALE

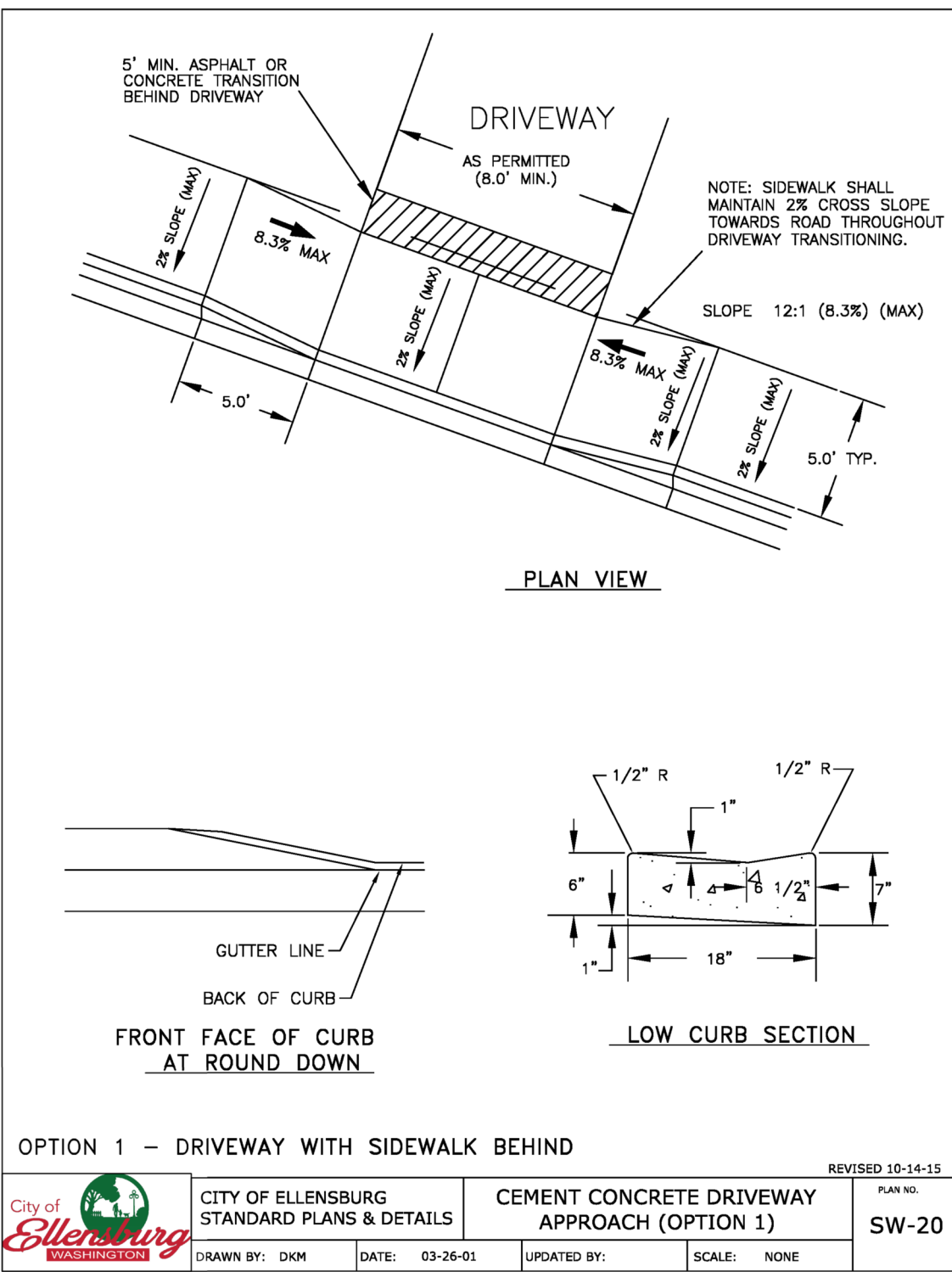
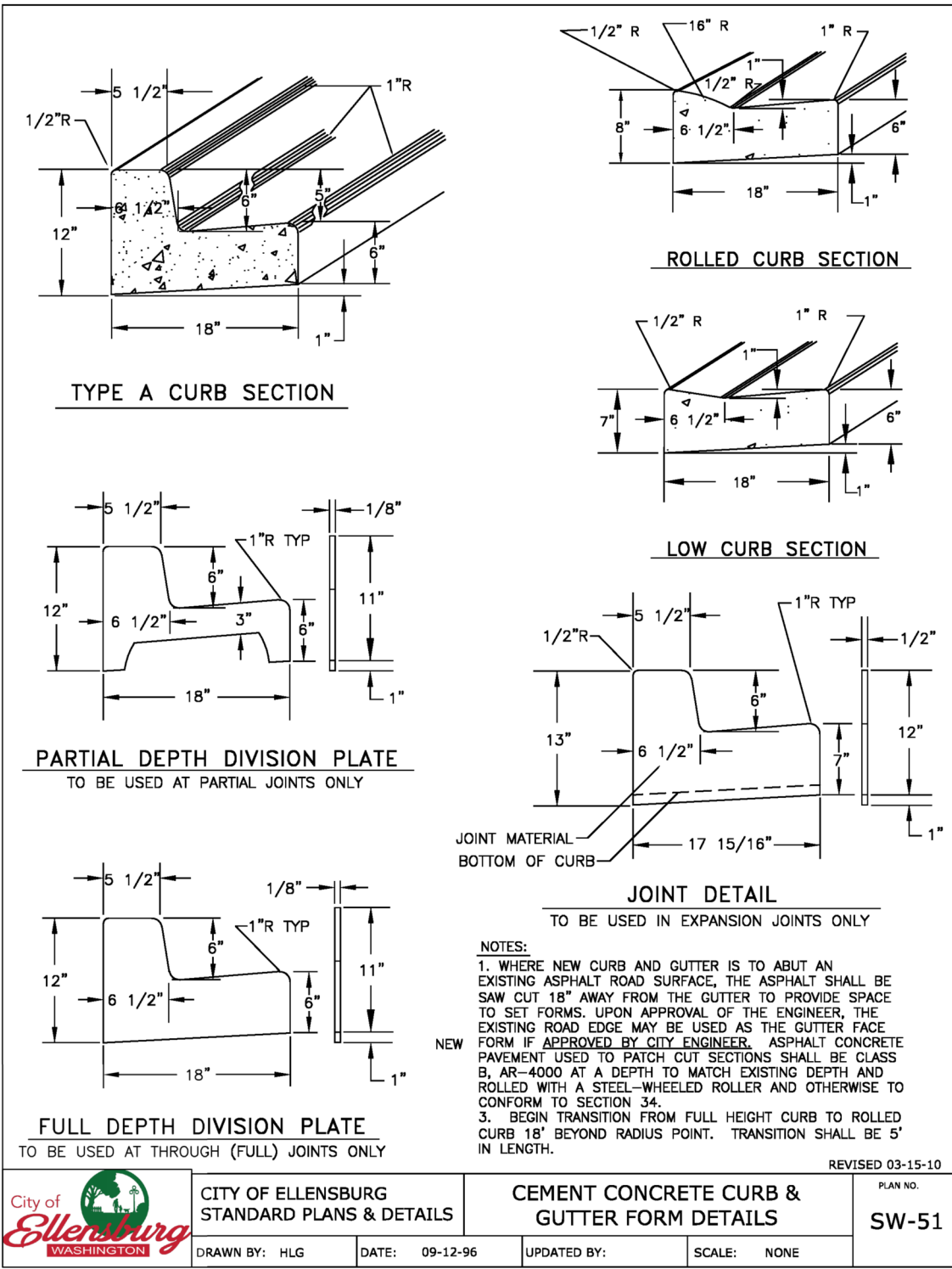
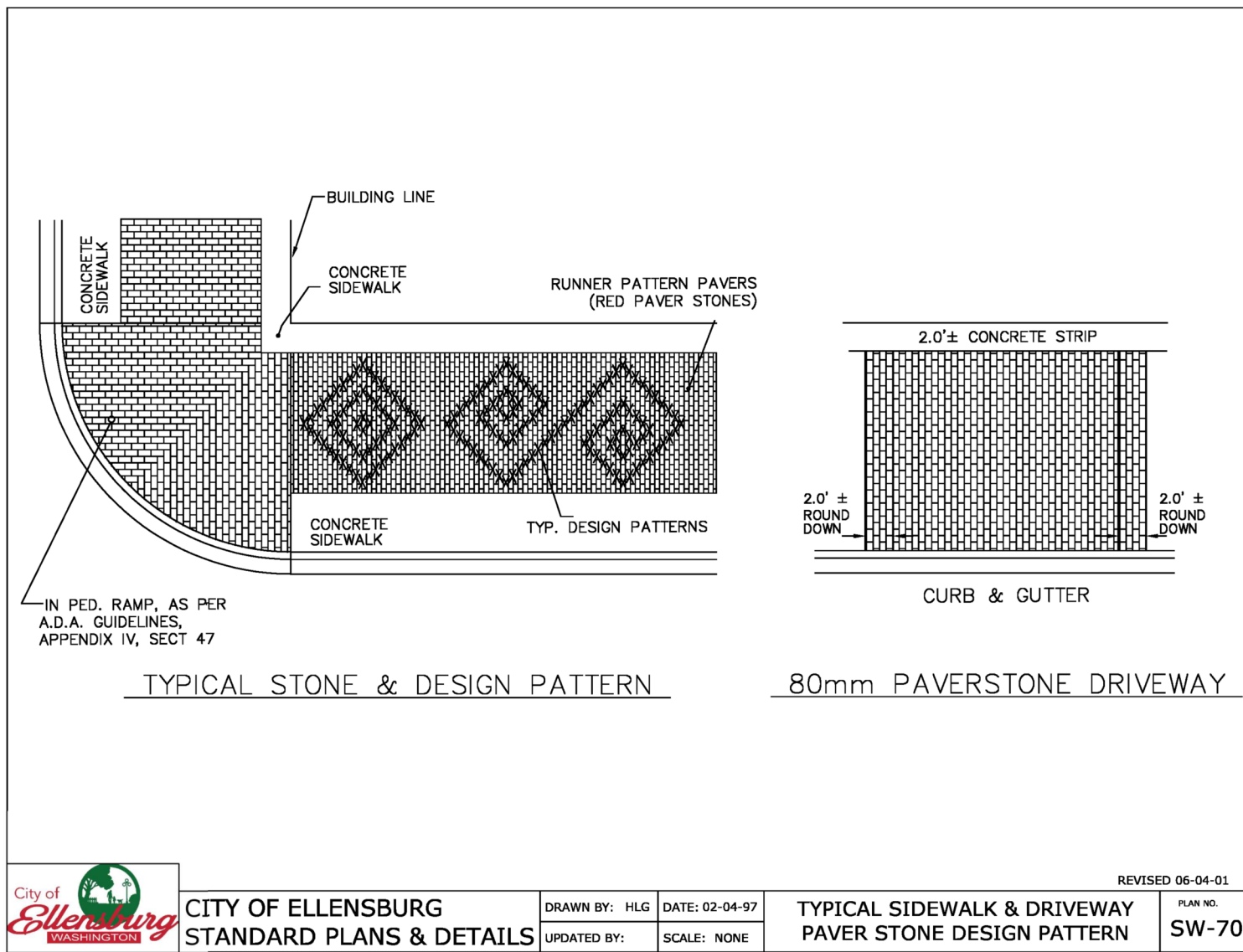
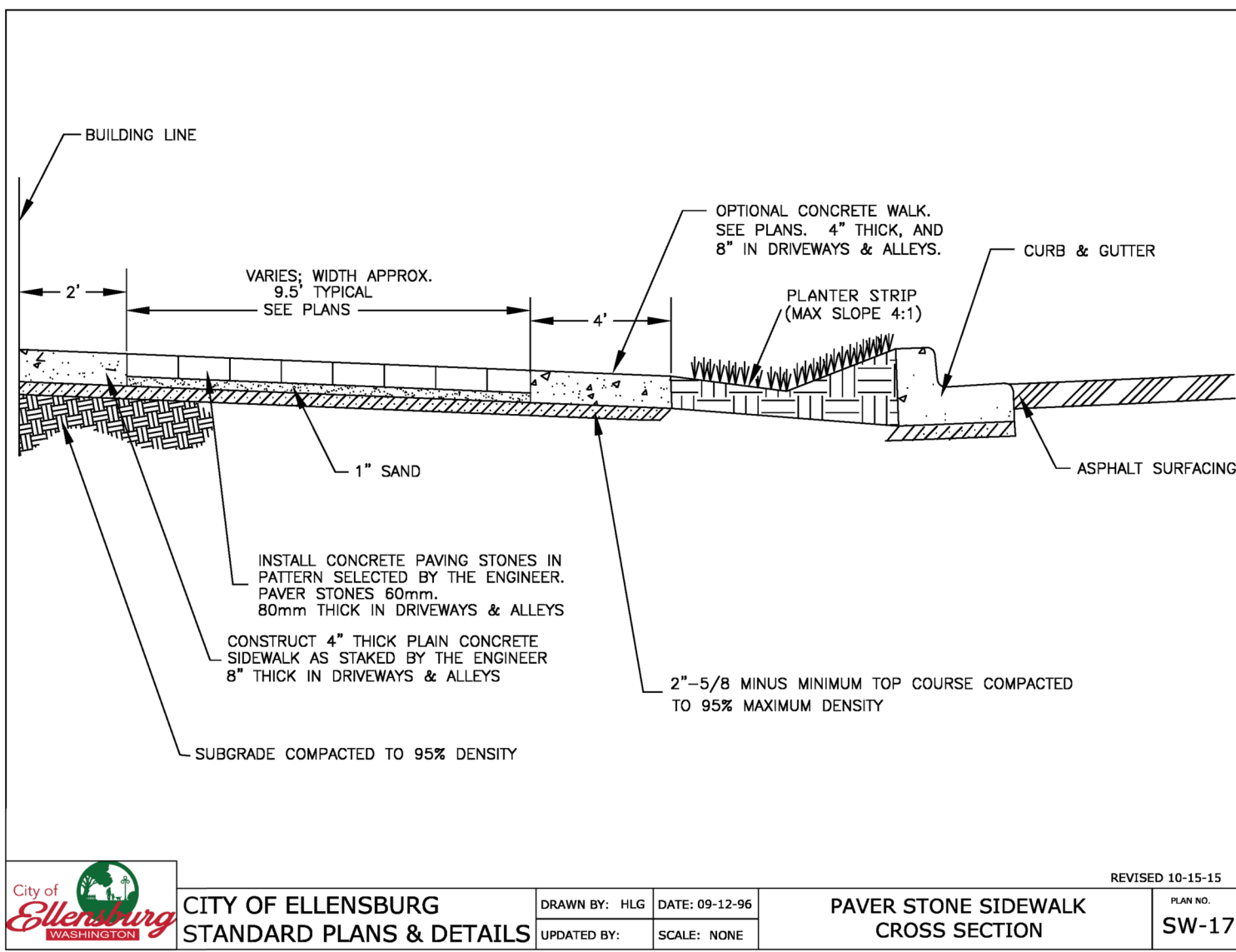
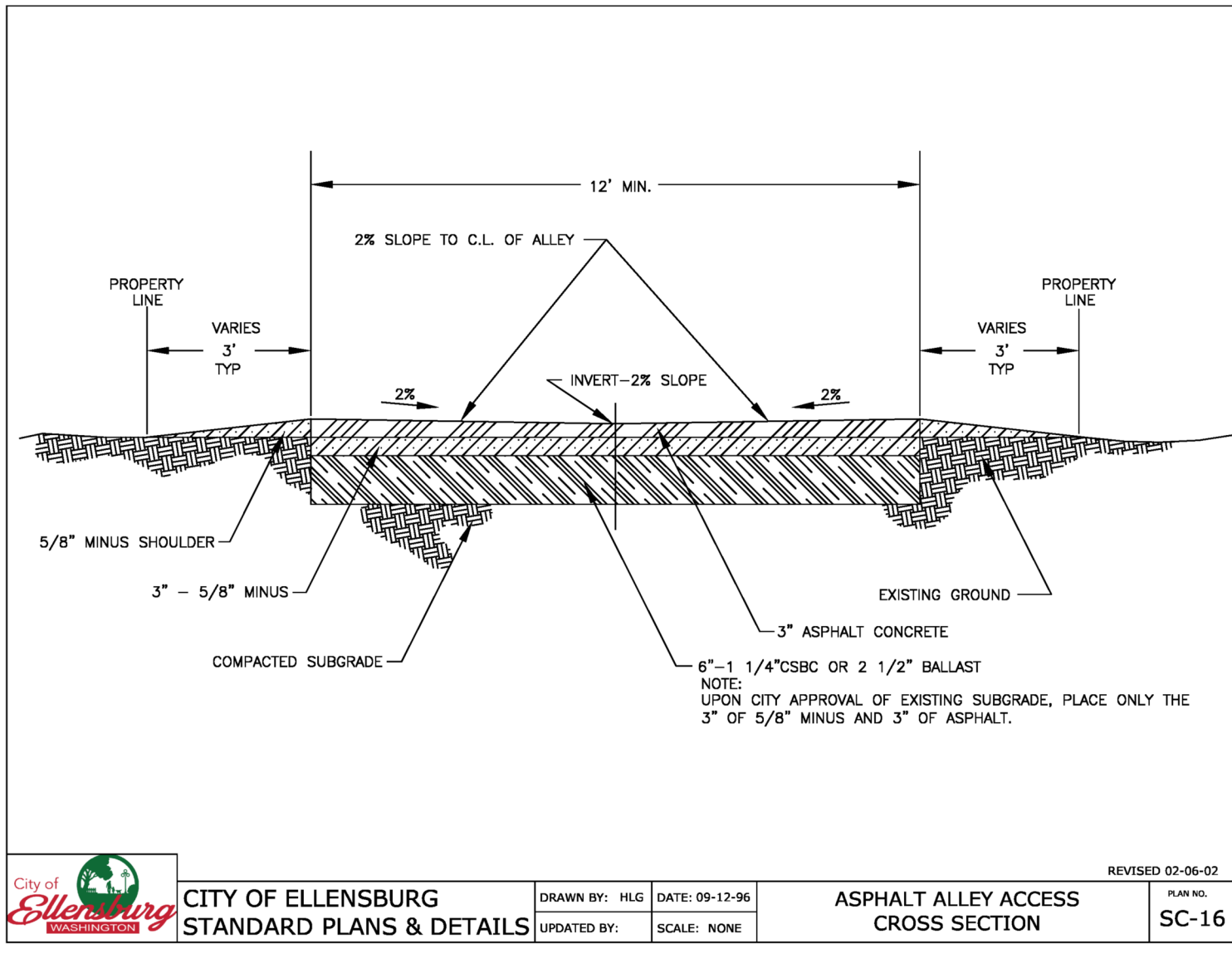
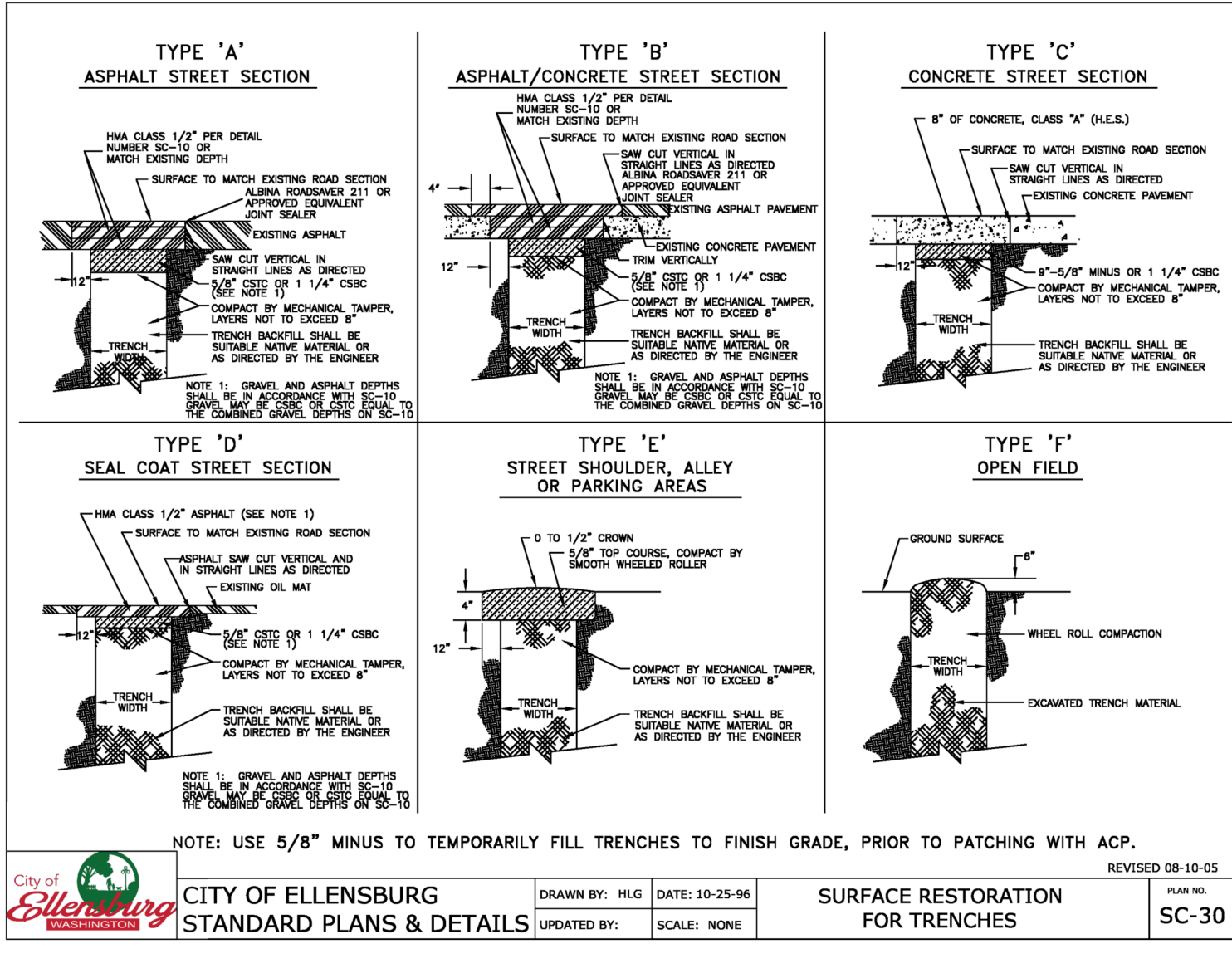

DATE  
xx/xx/2025

DRAWN BY  
T.K.L.

CHECKED BY  
S.D.G.

JOB NO.  
25022

DWG NAME

NEW DENTAL OFFICE

108 S. WATER STREET

ELLENSBURG, WASHINGTON

DR. IGOR ELPERIN

2906 W NOB HILL BLVD, YAKIMA, WA 98902 (917) 549-7026

PLSA

ENGINEERING-SURVEYING-PLANNING

521 N. 20TH AVE. STE. 3 YAKIMA, WASHINGTON (509) 575-6990

CITY OF YAKIMA

PROJ. ENG-XX-XXXX



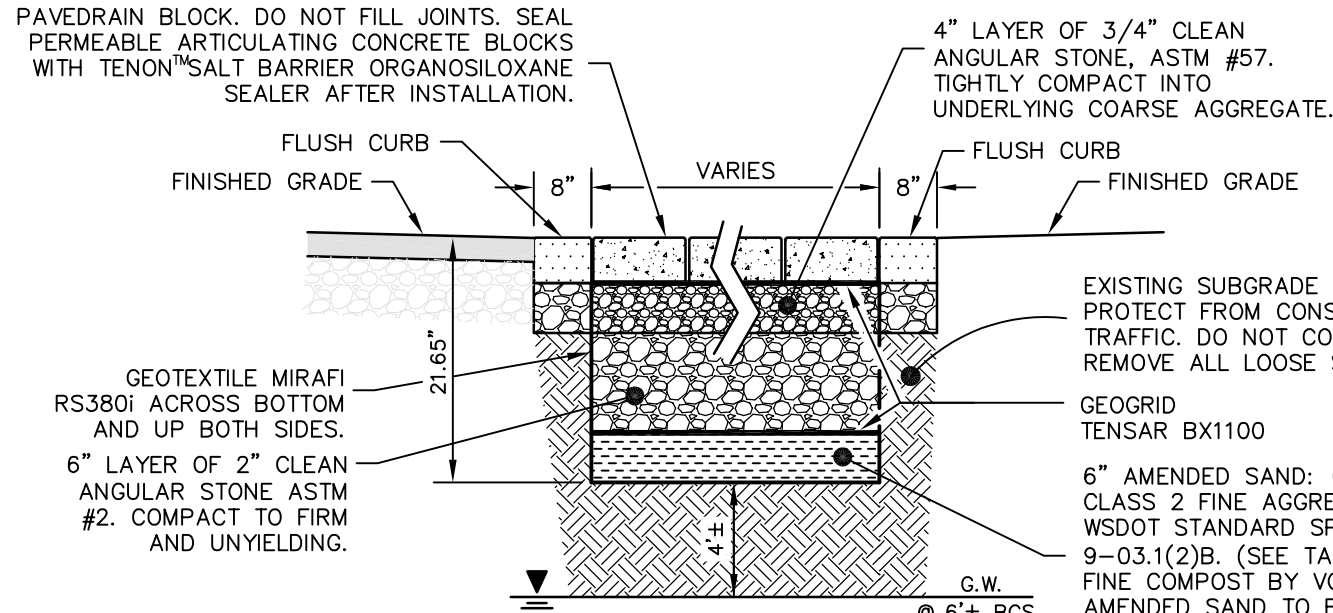

**PAVEDRAIN CONTACT INFORMATION**  
JEFF BUCH, PAVEDRAIN, LLC  
JBUCH@PAVEDRAIN.COM  
MOB (763) 292-0754

**TYPICAL PAVEDRAIN SECTION**  
NO SCALE

**PAVEDRAIN SYSTEM A**  
(3 ROWS X 53 CHAMBERS PER ROW)

INTERLOCKING BLOCK SECTION (5.65" HEIGHT x 2.83" WIDE x 53.5' LONG)  
#57 ROCK SECTION - (4" DEPTH x 2.83" WIDE x 53.5' LONG)  
#2 ROCK SECTION - (6" DEPTH x 2.83" WIDE x 53.5' LONG)  
AMENDED SAND SECTION - (6" DEPTH x 2.83" WIDE x 53.5' LONG)

**PAVEDRAIN SYSTEM B**  
(5 ROWS X 101 CHAMBERS PER ROW)

INTERLOCKING BLOCK SECTION (5.65" HEIGHT x 4.67" WIDE x 101.5' LONG)  
#57 ROCK SECTION - (4" DEPTH x 4.67" WIDE x 101.5' LONG)  
#2 ROCK SECTION - (6" DEPTH x 4.67" WIDE x 101.5' LONG)  
AMENDED SAND SECTION - (6" DEPTH x 4.67" WIDE x 101.5' LONG)

**PAVEDRAIN SYSTEM C**  
(5 ROWS X 25 CHAMBERS PER ROW)

INTERLOCKING BLOCK SECTION (5.65" HEIGHT x 4.67" WIDE x 25.5' LONG)  
#57 ROCK SECTION - (4" DEPTH x 4.67" WIDE x 25.5' LONG)  
#2 ROCK SECTION - (6" DEPTH x 4.67" WIDE x 25.5' LONG)  
AMENDED SAND SECTION - (6" DEPTH x 4.67" WIDE x 25.5' LONG)

**PAVEDRAIN SYSTEM E**  
(12 ROWS X 16 CHAMBERS PER ROW)

INTERLOCKING BLOCK SECTION (5.65" HEIGHT x 11.08" WIDE x 16.5' LONG)  
#57 ROCK SECTION - (4" DEPTH x 11.08" WIDE x 16.5' LONG)  
#2 ROCK SECTION - (6" DEPTH x 11.08" WIDE x 16.5' LONG)  
AMENDED SAND SECTION - (6" DEPTH x 11.08" WIDE x 16.5' LONG)

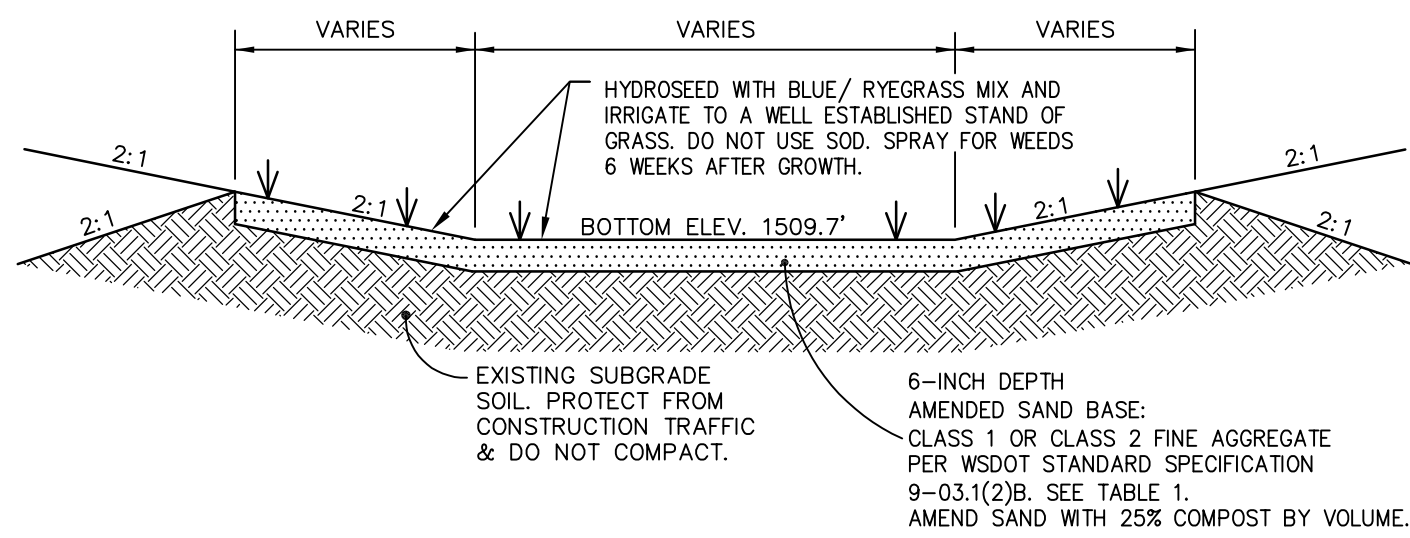

**BIO-INFILTRATION SWALE 'D'**  
NO SCALE

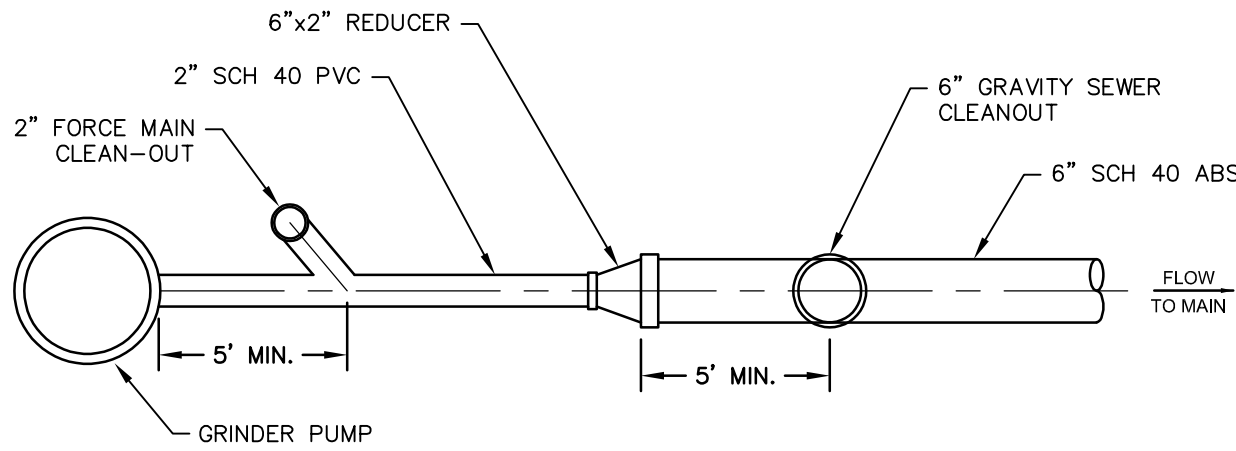

**FORCE SEWER SCHEMATIC LAYOUT**  
NO SCALE

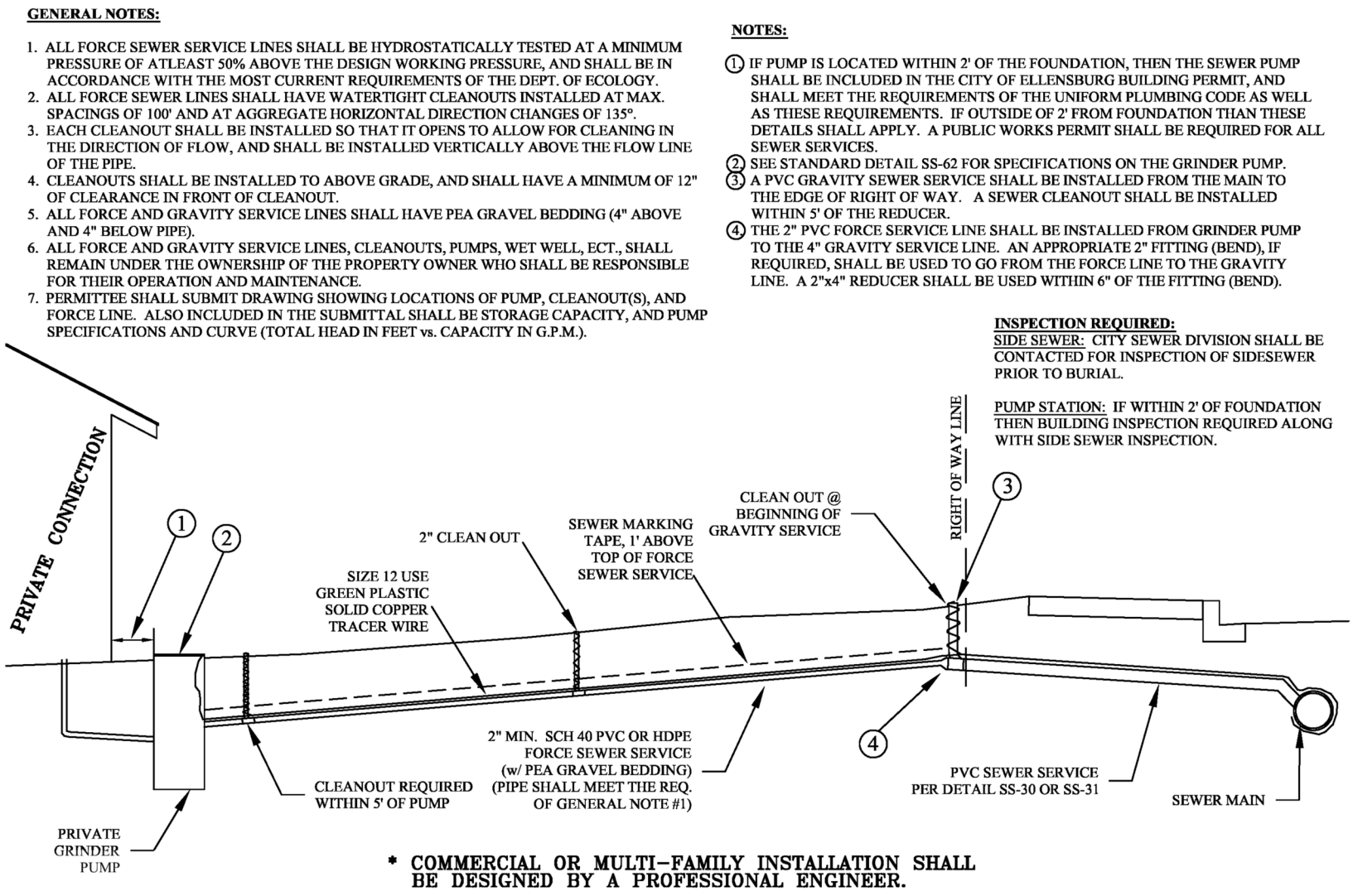

**CITY OF ELLENSBURG STANDARD PLANS & DETAILS**  
DRAWN BY: DKM DATE: 10-25-04  
UPDATED BY: SCALE: NONE  
PRIVATE FORCE SEWER SERVICE  
REVISED 06-01-11  
PLAN NO. SS-61

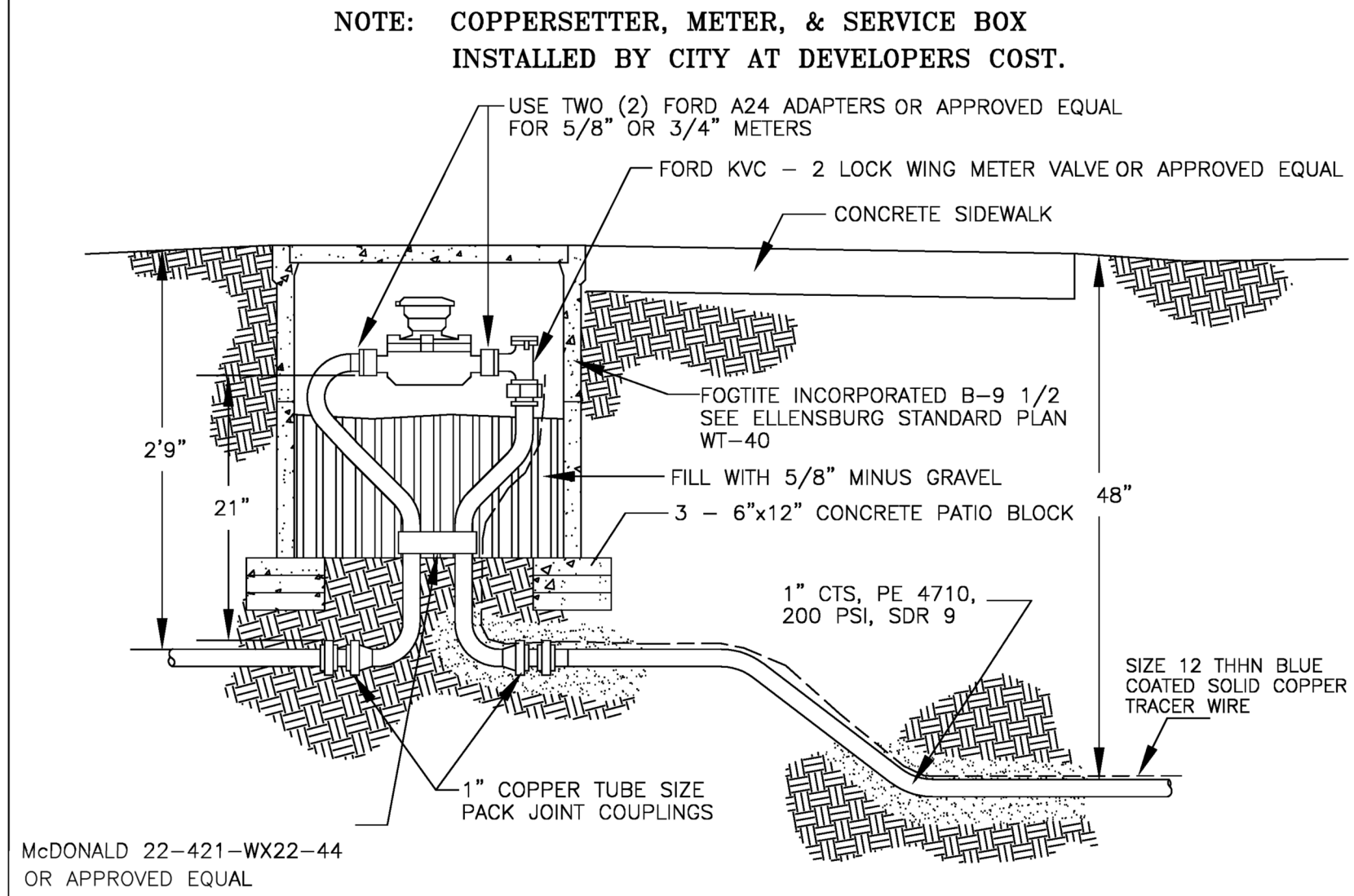
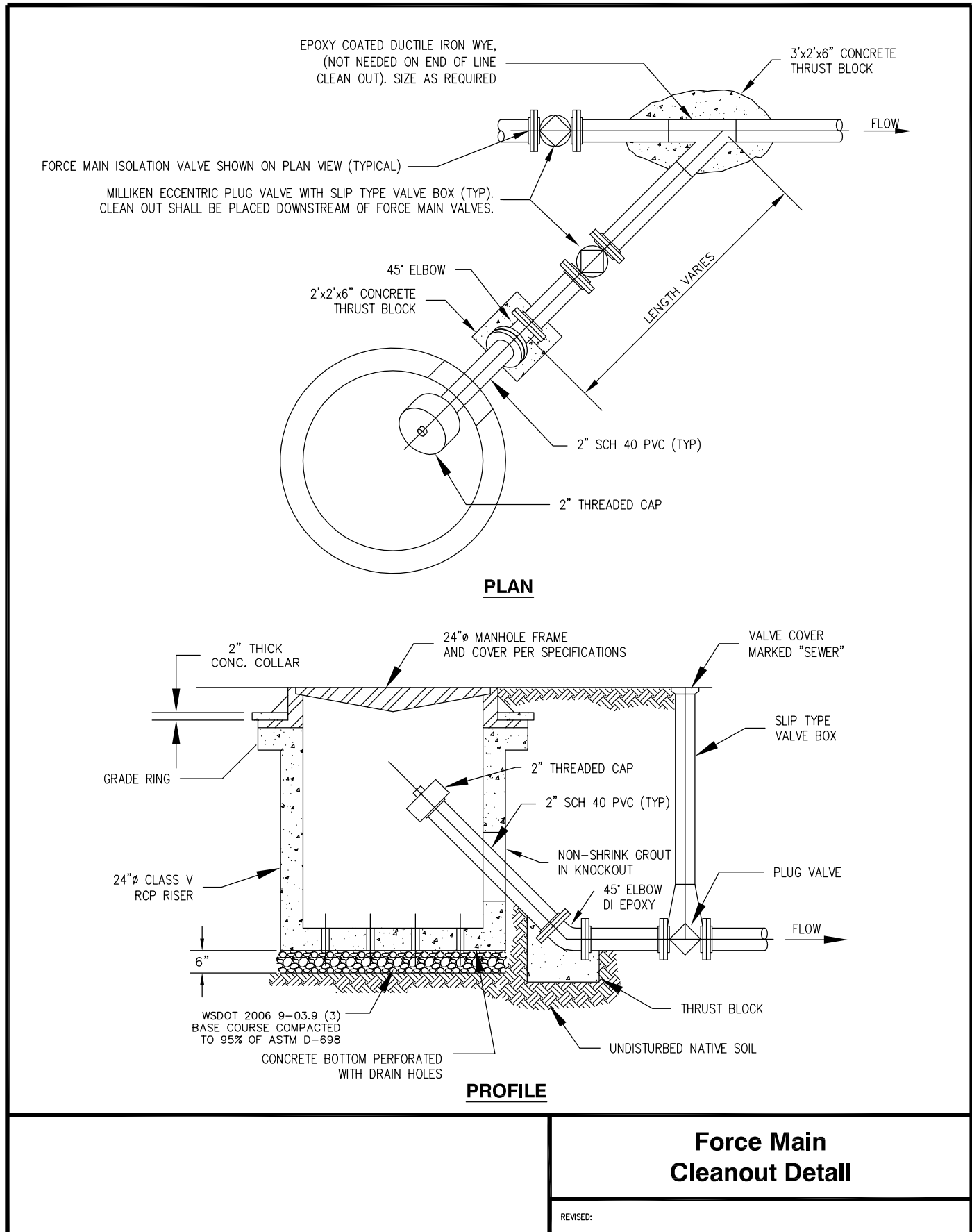

**CITY OF ELLENSBURG STANDARD PLANS & DETAILS**  
DRAWN BY: HLG DATE: 09-23-96  
UPDATED BY: DY SCALE: NONE  
5/8" OR 1" WATER SERVICE INSTALLATION  
REVISED 3-11-19  
PLAN NO. WT-25

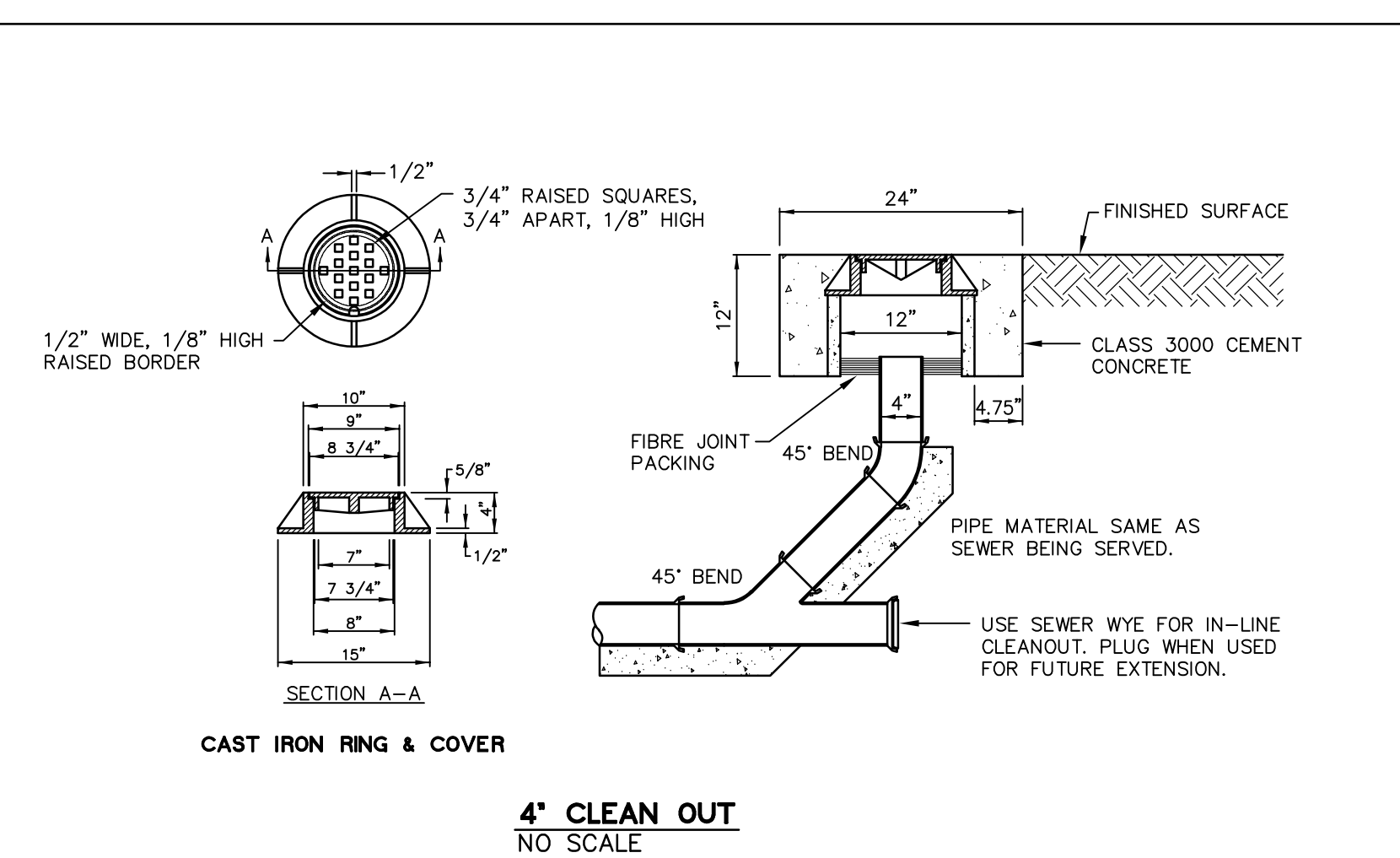
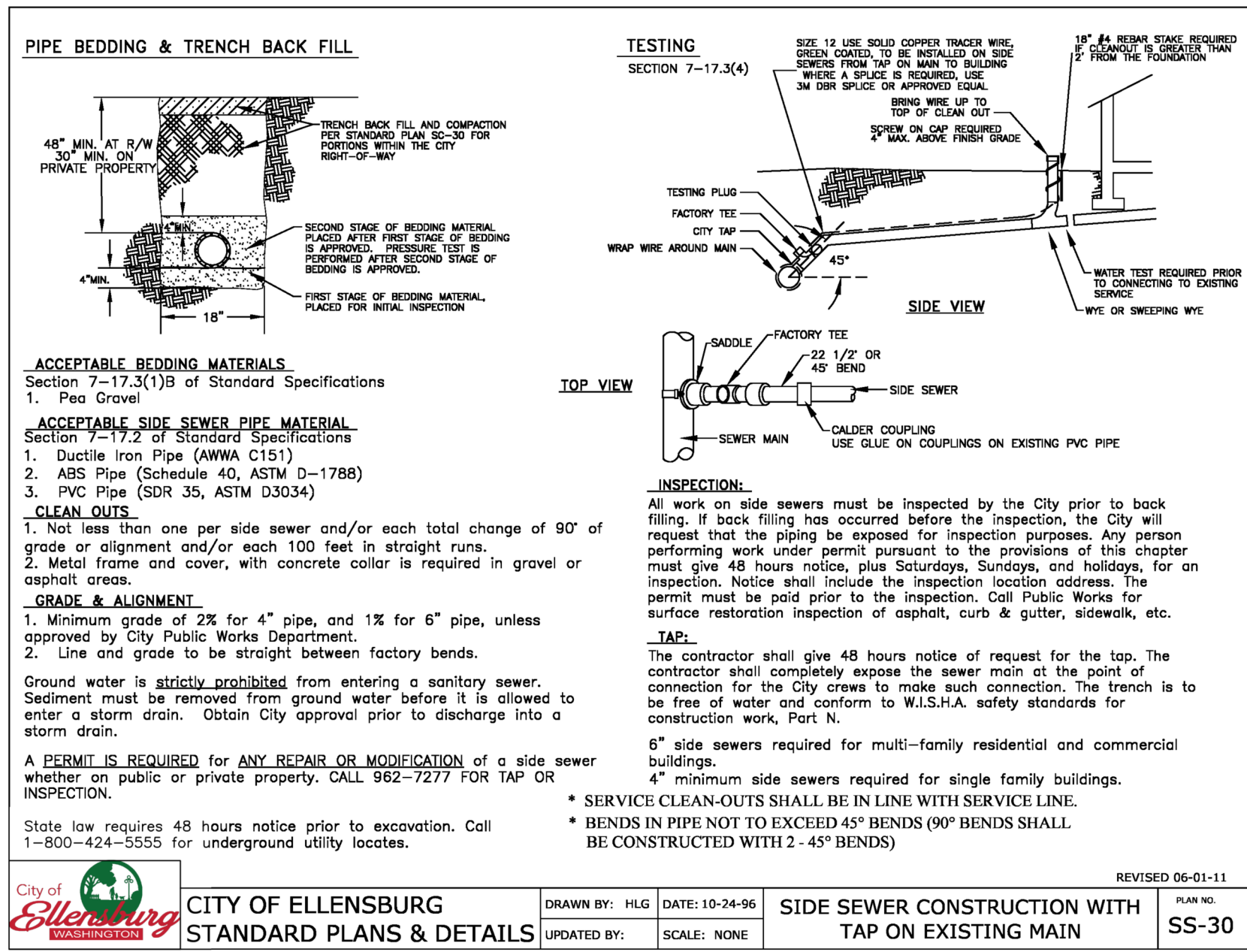

DATE									
REVISION									

**NEW DENTAL OFFICE DETAILS**  
**108 S. WATER STREET**  
**ELLENSBURG, WASHINGTON**  
PREPARED FOR  
**DR. IGOR ELPERIN**  
2906 W NOB HILL BLVD, YAKIMA, WA 98902 (917) 549-7026

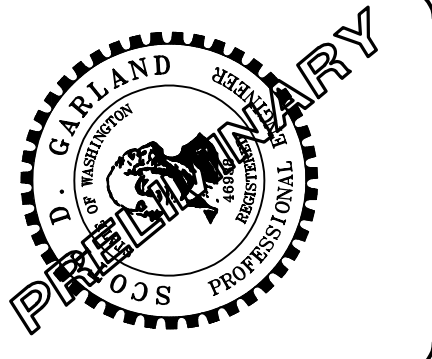

**PLSA**  
**ENGINEERING-SURVEYING-PLANNING**  
**521 N. 20TH AVE. STE. 3 YAKIMA, WASHINGTON (509) 875-6990**

DATE	12/23/2025
DRAWN BY	T.K.-L.
CHECKED BY	S.D.G.
JOB NO.	25022
DWG NAME	

**SHEET 4 of 4**  
OF  
**CITY OF YAKIMA**  
**PROJ. ENG-XX-XXXX**