



The primary objective of this community swimming pool is to provide all the citizens of Ellensburg with year-round recreational swimming. Scheduling will set aside specific block times for family swims, for senior citizens, and for instructional and organized swimming.



The multipurpose design of this facility lends itself well to education purposes; organized swimming instructions can be offered for all skill levels, as well as safety courses. For the competitive swimmer, the pool's conforming length standards make competitive events possible. In addition, it will provide an opportunity for Ellensburg to enter inter-city meets featuring competitive swimming, diving, and water ballet.

On November 7, at 6:30 p.m., KXLE Radio will host an open forum, question and answer program which will provide the citizens of Ellensburg with a chance to ask their questions on the proposed \$600,000 Ellensburg Swimming Pool Bond Issue.

For further information, call members of the Pool Committee.

Maralyn Ellison - Co-Chairperson	925-3953	Elinor Fisher	925-5038
Brian Barto - Co-Chairperson	925-3326	Mike Johnson	925-3463
Pat Falkner - Secretary	925-1347	Joe Kelleher	962-9553
Jeannette Geoghegan	962-2050	E. E. Samuelson	925-2694
Russ Goodburn	962-2815	Dottie Simonis	925-3796
Cathy Nisbet	962-9604	Amy Barker	962-2202

● REMEMBER: VOTE NOVEMBER 8th ●

Ellensburg TOPICS

November, 1977

Published by the City of Ellensburg

An Equal Opportunity Employer

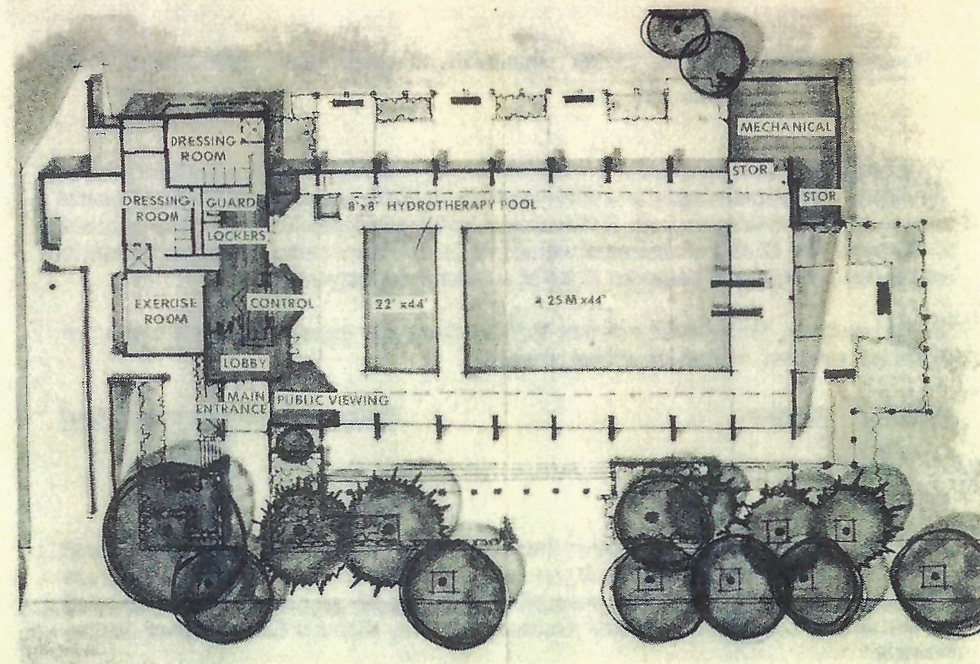

INTRODUCTION

In 1950 the City of Ellensburg opened a community pool at Memorial Park. Over a period of twenty-three years, this facility provided the community with outdoor swimming. The facility was closed in 1973. Attempts to renovate the pool have been unsuccessful, and Ellensburg has been without a community pool since then. In early 1977, the City's pool consultant, The O.R.B. Organization recommended the City abandon the existing pool because it is economically unfeasible to rehabilitate.

On November 8, the citizens of Ellensburg will be asked to vote on a \$600,000 Swimming Pool Bond Issue. Before making a decision, it is best to understand those costs and benefits associated with a 'yes' or 'no' vote. This edition of Topics will focus on those costs to enable citizens to make a more informed decision on November 8.

WHAT WILL THIS FACILITY COST?

The total project is estimated to cost 1.3 million dollars. This total cost includes construction of the swimming pool and its enclosure with all the mechanical systems. It also includes the demolition of the existing pool and preparation of the site.

The City has received a state and federal grant for \$565,000. In addition, it has set aside \$135,000 (for a total of \$700,000) to be used in the construction of a community pool. To adequately finance the cost of this project, the City proposes to issue \$600,000 in General Obligation Bonds. These bonds would be repaid from property tax revenues levied on property within the City of Ellensburg. The time needed to retire these bonds would be twenty years, as this length of time provides a reasonable interest rate and a minimum annual cost to the property owner.

The cost for each property owner will depend upon the assessed valuation of the property. To calculate the cost for the first year of these bonds: First find the assessed valuation of the property, divide this number by 1,000 and multiply by .46.

Assessed value of property \$20,000 equals $20 \times .46$ which equals \$9.20 Annual Cost
divided by 1,000 for
1st Year

What you have calculated is the annual cost to the property owner for the first year of the bond. These bonds have a twenty year life, and the annual cost to the property owner will decrease each year. For example, in ten years the 46 cents will be reduced to 36 cents per \$1,000 of assessed valuation. In the final year, bond retirement is estimated to require 28 cents per \$1,000 of assessed property value.

On the average, the property owner in Ellensburg can expect to pay 36 cents per \$1,000 of assessed valuation of the property.

<u>Assessed Valuation</u>	<u>Estimated Average Annual Cost</u>
\$10,000	\$ 3.60
\$20,000	\$ 7.20
\$30,000	\$10.80

If the citizens of Ellensburg support this swimming pool bond issue, the levy would appear on 1979 property tax bills. If you are retired, receiving social security or are disabled, you may qualify for an exemption from regular property tax as well as all excess levies. Contact the County Assessor's Office, Kittitas County Court House, 925-4138.

OPERATION AND MAINTENANCE COSTS

The estimated annual cost to operate and maintain the pool is \$86,000. This cost will include a pool manager (hired by the City), lifeguards, bathhouse personnel and other expenses such as utilities, insurance, chemicals and general maintenance of the pool complex.

These costs will be financed primarily from user fees. It is estimated that the revenues generated by these fees will produce a minimum of \$63,000 per year or 73 percent of estimated operation and maintenance costs. The fees used to estimate revenues are \$1 for adults and \$.50 for children.

Swimming pools, like other City facilities, are not totally self-supporting. The additional \$23,000 needed to meet operation and maintenance costs will be financed through existing sources of revenues or higher non-resident user fees. This will assure no additional increases in taxes and only minimum impact on general revenues.

Both the school district and the County have been contacted, and they are considering participation in the pool's operation and maintenance costs. The share they contribute will be based on use.

A COMMUNITY POOL TO MEET COMMUNITY NEEDS

The pool will be an indoor facility designed for year-round use, to be opened 360 days a year. It will be built on the existing site of the Memorial Park Pool, using as much of the existing structure as possible and occupying approximately the same area. The agency providing the state and federal funds requires that the pool be part of a park complex, located at or near the population and geographical center of the community.

The pool complex will include a main swimming tank 82' (25 meters) x 44' with a 12' deep end for diving, tapering to a 3' deep shallow end. Adjacent to the main tank will be a smaller 22' x 44' tank with a depth of 1'6" to 2'6" for wading and beginning swimmers and an 8' x 8' hydrotherapy pool, exercise room and sauna. A bathhouse will consist of separate dressing rooms, showers and toilet facilities for men and women. Both lockers and baskets will be provided for clothing storage. Overlooking the pool area will be a control station serving as a manager - first-aid office. All facilities have been designed to provide use and access for the physically handicapped. Incorporated into the design is an auxiliary solar powered heating system which will help reduce energy requirements. The new pool has a design capacity of 360 people. Its estimated life expectancy, with normal maintenance, is forty years.

